



EDIT PDF

You can edit this PDF for free with Jotform.



Equipment Rental Agreement

ACME WOODWORK Company
3147 Patterson Street, Houston, TX, 77002

info@acmeglobal.com
www.acmeglobal.com
(123) 1234567

Owner Information

Owner Name

Owner Email

Owner Phone Number

Owner Address

Renter Information

Renter Name

Renter Email

Renter Phone Number

Renter Address

Equipment Information

Description of Equipment	Serial No.	Number of Items

Total Value of Equipment (\$)

Rental Information

Rent Start Date

Rent End Date

Monthly Rental Amount (\$)

Payments will be Collected by

Payment Due Date

Payment Due Date

Initial Payment

Security Deposit (\$)

TERMS & CONDITIONS

1. Parties

This Equipment Rental Agreement (shall be referred as "**Agreement**" hereinafter) has been signed between _____ ("**Lessor**" hereinafter) and _____ ("**Lessee**" hereinafter) on _____.

The parties have agreed to lease the above-mentioned equipment under the following terms and conditions.

2. Term of Agreement

This Agreement enters into force on _____ and will remain in effect for _____. At the end of the rental period, the Agreement will automatically terminate without any warning or notice, but the parties may decide to extend the period in writing, or they may sign a new contract with new terms and conditions.

3. Price and Payment Conditions

The total price of this Agreement is _____. _____ of this amount will be paid in advance and the balance amount shall be paid in equal installments. All payments shall be made by _____.

Payment will be made on the _____ day of the month at the latest. In case of late payment, _____ late payment interest is applied.

4. Rights And Obligations of the Parties

- Leased equipment can only be used by the users or operators assigned by the Lessor. Except for the user/operator of the leased equipment, all damages (regardless of the defect rate) that may occur due to the use of third parties shall be covered by the Lessee.
- The lessor accepts that he has received the product undamaged and is responsible for any damage and loss that may occur to the product. The product price to be determined by the Lessor is collected from the Lessor. The Lessor cannot return a product different from the product delivered by the Lessor.

- The Lessee agrees and undertakes to take all kinds of security measures in the place where the rented equipment will be used, and to fulfill the suggestions and requests of the user/operator. For this reason, the Lessee is responsible for any damages that may occur within the working area.
- If the Lessor gives up the product for which he/she has paid or left the deposit, he/she cannot demand a refund, but has the right to rent another product within 6 months as much as the amount he/she has paid.
- All kinds of malfunctions that occur during the use of the Lessee will be repaired by the Lessee at a cost. The Lessor accepts and undertakes that the repair will be made by authorized and competent services and using original products.
- In case of loss of rented equipment, the Lessee immediately notifies the Lessor of this and pays the Lessor the current cost of the equipment upon request.
- If the Lessee wishes to make any changes or improvements to the leased equipment, he/she first obtains the Lessor's written consent. Under no circumstances can the Lessor be charged for these alterations and improvements.
- The lessee may only use the leased equipment for legitimate purposes.
- The Lessor is liable to pay a penalty of _____ per day, in case he refuses to return the leased equipment despite the expiry of the contract.

5. Security Deposit

The Lessee agrees to pay a security deposit of \$ _____. This should be refunded upon returning the equipment or termination of this Agreement. The Security Deposit will cover for any damage to the equipment.

6. Insurance

The Lessee agrees to purchase and maintain appropriate insurance for the rented equipment/s. The certificate of insurance shall be given to the Lessor upon request.

7. Miscellaneous

- **Amendment** - Any amendments or variation to this Agreement shall be in writing with the mutual consent of both parties.
- **Notifications** - Any notifications to be made by the parties within the scope of this Agreement shall be made to the addresses indicated in this Agreement.
- **Entire Agreement** - This Agreement constitutes the complete understanding of the parties to this Agreement regarding the subject matter contained in this Agreement and supersedes any and all other agreements or arrangements, either oral or in writing.
- **Severability** - If any provision of this Agreement is held in whole or in part to be unenforceable for any reason, the remainder of that provision and of the entire agreement shall be severable and remain in effect.
- **Governing Law** - This Agreement shall be governed by and construed in accordance with the laws of the State of _____.

Date of Execution

Lessor Signature

Lessee Signature



Thanks for using **Equipment Rental Agreement Template!** To edit this PDF with **Jotform Sign**, sign up for a free Jotform account today.

[EDIT PDF](#)

Learn More About Jotform PDF Products

Jotform offers powerful PDF solutions. Check them out below.

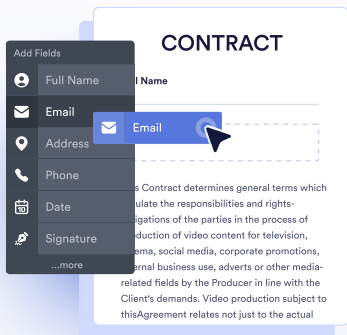

JOTFORM PDF EDITOR

Turn form submissions into PDFs automatically — ready to download or save for your records.

[Go to PDF Editor >](#)

SMART PDF FORMS

Convert your PDF files into online forms that are easy to fill out on any device.

[Go to Smart PDF Forms >](#)

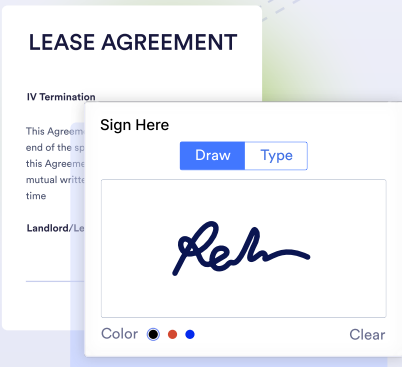
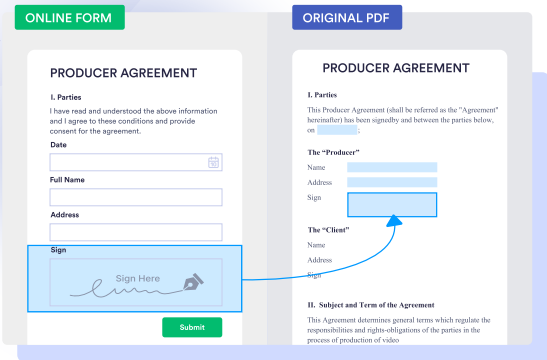

JOTFORM SIGN

Collect e-signatures with Jotform Sign to automate your signing process.

[Go to Jotform Sign >](#)

These templates are suggested forms only. If you're using a form as a contract, or to gather personal (or personal health) info, or for some other purpose with legal implications, we recommend that you do your homework to ensure you are complying with applicable laws and that you consult an attorney before relying on any particular form.