



**EDIT PDF**

You can edit this PDF for free with Jotform.

# Fence Contract

This **Fence Installation Contract** ("**Contract**") is entered into on \_\_\_\_\_ ("**Effective Date**") between the parties below:

**Contractor**

**Client**

**WHEREAS**, the Client desires to have a fence installed on their property, and the Contractor represents that it has the necessary skills, experience, and resources to perform such work;

**NOW, THEREFORE**, in consideration of the mutual promises set forth below, the parties agree as follows:

## 1. Scope of Work

The Contractor shall supply all labor, materials, tools, and equipment necessary to design, construct, and install a fence at the Client's property located at

The work shall include, at a minimum:

- Site preparation and marking of fence boundaries
- Supply and installation of fencing materials
- Installation of posts, panels, gates, and hardware
- Cleanup and removal of debris upon completion

Detailed specifications of the fence are as follows:

Description	Details
Fence Type	
Height	
Lenght	
Color/Finish	
Gate(s)	
Additional Features	

Any work not expressly included in this section shall be considered outside the scope and may require a written change order.

## 2. Contract Price and Payment Terms

The total contract price for the work shall be \_\_\_\_\_ (***“Contract Price”***).

Payment shall be made as follows:

Payment Stage	Amount	Due Date/Condition
Deposit		Upon signing this Contract
Progress Payment		
Final Payment		Upon completion of the work

Payments not made when due may result in suspension of work until payment is received.

## 3. Project Timeline

Work shall commence on or about \_\_\_\_\_ and is expected to be substantially completed by \_\_\_\_\_, subject to reasonable delays.

The Contractor shall promptly notify the Client of any delays caused by weather, material shortages, site conditions, or other circumstances beyond the Contractor’s control.

## 4. Permits and Approvals

Unless otherwise agreed in writing, the Client shall be responsible for obtaining all necessary permits, approvals, and permissions required for the installation of the fence.

The Contractor shall reasonably cooperate by providing documentation or information required for such permits.

## **5. Site Conditions and Access**

The Client shall provide the Contractor with reasonable access to the property during normal working hours.

The Client is responsible for:

- Identifying property boundaries accurately
- Disclosing underground utilities, easements, or obstructions to the extent known

The Contractor shall not be responsible for damage caused by undisclosed or inaccurately identified underground conditions.

## **6. Changes to the Work**

Any modification to the scope, materials, design, or timeline must be documented in a written change order signed by both parties.

The change order shall specify any adjustments to the Contract Price and completion date.

## **7. Warranty**

The Contractor warrants that the work will be performed in a professional manner consistent with industry standards.

The Contractor further warrants that:

- Labor shall be free from defects for a period of \_\_\_\_\_
- Materials shall be subject to manufacturer warranties, if applicable

This warranty does not cover damage caused by misuse, neglect, natural events, or unauthorized modifications.

## **8. Insurance and Liability**

The Contractor shall maintain appropriate insurance coverage, including general liability insurance, during the performance of the work.

Each party shall be responsible for its own acts and omissions. Neither party shall be liable for indirect or consequential damages arising from this Contract.

## 9. Termination

Either party may terminate this Contract by providing written notice to the other party:

- **For cause**, if the other party materially breaches its obligations and fails to cure such breach within a reasonable time after receiving notice
- **Without cause**, upon \_\_\_\_\_ written notice

Upon termination:

- The Client shall pay for all work completed up to the termination date
- The Contractor shall cease work and secure the site in a reasonable manner

## 10. Dispute Resolution and Governing Law

This Contract shall be governed by the laws of \_\_\_\_\_.

In the event of a dispute, the parties agree to attempt to resolve the matter through good faith negotiation before pursuing legal remedies.

## 11. Entire Agreement

This Contract constitutes the entire agreement between the parties and supersedes all prior discussions, agreements, or understandings.

## 12. Amendments

This Contract may only be amended by a written document signed by both parties.

## 13. Notices

Any notice required under this Contract shall be in writing and delivered to the addresses of the parties set forth above.

By signing below, the parties acknowledge that they have read, understood, and agreed to the terms of this Contract.

**Contractor**

**Name**

**Date**

**Signature**

**Client**

**Name**

**Date**

**Signature**

\_\_\_\_\_

\_\_\_\_\_



Thanks for using **Fence Contract Template!** To edit this PDF with **Jotform Sign**, sign up for a free Jotform account today.

[EDIT PDF](#)

## Learn More About Jotform PDF Products

Jotform offers powerful PDF solutions. Check them out below.

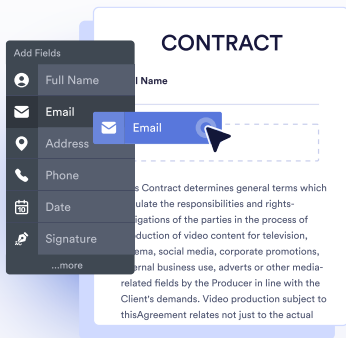

### JOTFORM PDF EDITOR

Turn form submissions into PDFs automatically — ready to download or save for your records.

[Go to PDF Editor >](#)

### SMART PDF FORMS

Convert your PDF files into online forms that are easy to fill out on any device.

[Go to Smart PDF Forms >](#)

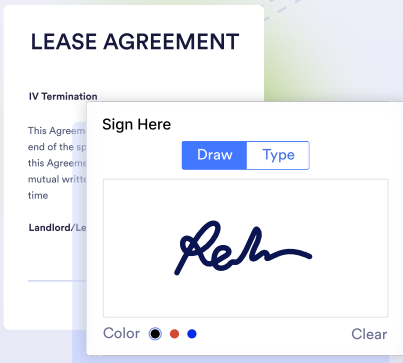
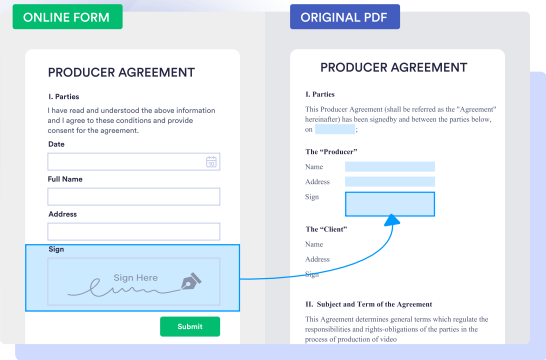

### JOTFORM SIGN

Collect e-signatures with Jotform Sign to automate your signing process.

[Go to Jotform Sign >](#)

*These templates are suggested forms only. If you're using a form as a contract, or to gather personal (or personal health) info, or for some other purpose with legal implications, we recommend that you do your homework to ensure you are complying with applicable laws and that you consult an attorney before relying on any particular form.*