



EDIT PDF

You can edit this PDF for free with Jotform.

Warranty Agreement

This **Warranty Agreement** ("**Agreement**") is entered into on _____ ("**Effective Date**")

by and between the parties below:

Provider

Customer

Provider and Customer may be referred to individually as a "**Party**" and collectively as the "**Parties.**"

1. Purpose

This Agreement sets out the terms and conditions under which the Provider offers a warranty for the products or services described below. The intent of this Agreement is to define the scope of warranty coverage, the responsibilities of the Parties, and the procedures for making and resolving warranty claims.

2. Warranty Coverage

The Provider warrants that the following product(s) or service(s) ("**Covered Items**") shall be free from defects in materials and workmanship under normal use:

Description of Covered Item	Model/Reference	Serial Number	Date of Delivery

The warranty applies only to defects that arise under normal and intended use during the Warranty Period.

3. Warranty Period

The warranty coverage under this Agreement shall commence on the date of delivery or completion, as applicable, and shall continue for a period of _____ ("**Warranty Period**"), unless terminated earlier in accordance with this Agreement.

4. Scope of Warranty

During the Warranty Period, the Provider agrees to, at its discretion:

- Repair the defective Covered Item;
- Replace the defective Covered Item with a new or refurbished equivalent; or
- Provide a refund or credit equivalent to the original purchase price, where repair or replacement is not reasonably feasible.

The Provider shall determine the appropriate remedy based on the nature of the defect and availability of replacement options.

5. Customer Obligations

To maintain warranty coverage, the Customer agrees to:

- Use the Covered Items in accordance with any provided instructions, manuals, or specifications;
- Perform routine maintenance where applicable;
- Promptly notify the Provider upon discovering any defect;
- Provide reasonable access or return of the Covered Item for inspection and repair.

Failure to comply with these obligations may result in denial of warranty coverage.

6. Exclusions

This warranty does not cover:

- Damage caused by misuse, abuse, or improper handling;
- Unauthorized modifications or repairs performed by parties other than the Provider or its authorized representatives;
- Normal wear and tear;
- Damage resulting from external factors such as accidents, environmental conditions, or power fluctuations;
- Consumable parts or components intended for limited use, unless otherwise specified.

7. Warranty Claim Procedure

To initiate a warranty claim, the Customer must:

- Notify the Provider in writing within the Warranty Period, providing details of the defect;
- Submit proof of purchase or delivery;
- Follow any return or inspection instructions provided by the Provider.

The Provider shall assess the claim within a reasonable timeframe and inform the Customer of the outcome and next steps.

8. Limitation of Liability

To the fullest extent permitted by applicable law, the Provider's liability under this Agreement shall be limited to the remedies expressly stated in the Scope of Warranty clause.

The Provider shall not be liable for indirect, incidental, or consequential damages, including loss of profits, loss of use, or business interruption arising from any defect or failure of the Covered Items.

9. Termination

This Agreement shall terminate automatically upon expiration of the Warranty Period.

The Provider may terminate this Agreement earlier if the Customer materially breaches its obligations, including misuse of the Covered Items or failure to comply with the Customer Obligations clause.

Termination shall not affect any valid claims submitted prior to the termination date.

10. Governing Law and Dispute Resolution

This Agreement shall be governed by and interpreted in accordance with the laws of _____.

Any disputes arising out of or in connection with this Agreement shall first be addressed through good faith negotiations between the Parties. If unresolved, the dispute shall be submitted to the competent courts of _____, unless the Parties agree otherwise in writing.

11. Amendments

This Agreement may be amended only by a written document signed by both Parties. Any modification shall apply prospectively unless expressly stated otherwise.

12. Entire Agreement

This Agreement constitutes the entire understanding between the Parties regarding the subject matter and supersedes all prior discussions, representations, or agreements, whether written or oral.

13. Signatures

IN WITNESS WHEREOF, the Parties have executed this Warranty Agreement as of the Effective Date first written above.

Provider

Customer

Name

Name

Date

Date

Signature

Signature



Thanks for using **Warranty Agreement Template!** To edit this PDF with **Jotform Sign**, sign up for a free Jotform account today.

[EDIT PDF](#)

Learn More About Jotform PDF Products

Jotform offers powerful PDF solutions. Check them out below.

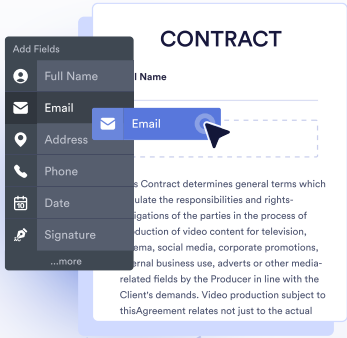

JOTFORM PDF EDITOR

Turn form submissions into PDFs automatically — ready to download or save for your records.

[Go to PDF Editor >](#)

SMART PDF FORMS

Convert your PDF files into online forms that are easy to fill out on any device.

[Go to Smart PDF Forms >](#)

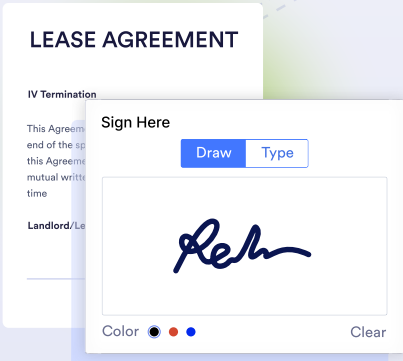
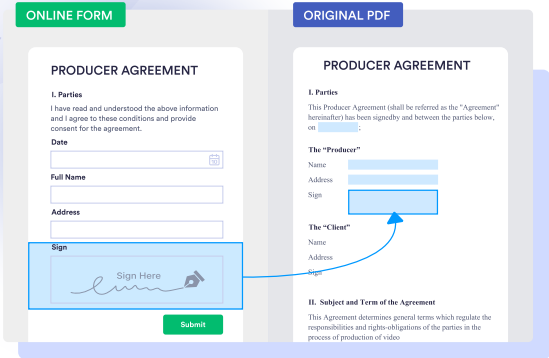

JOTFORM SIGN

Collect e-signatures with Jotform Sign to automate your signing process.

[Go to Jotform Sign >](#)

These templates are suggested forms only. If you're using a form as a contract, or to gather personal (or personal health) info, or for some other purpose with legal implications, we recommend that you do your homework to ensure you are complying with applicable laws and that you consult an attorney before relying on any particular form.