



Waste Management Service Agreement

This Waste Management Service Agreement was executed on _____.

This Agreement is between the following parties:

Service Provider

Client or Waste Generator

SERVICE ACCEPTANCE

As per this Waste Management Service Agreement, the Service Provider agrees to collect and dispose of Waste products and confirms that they will be responsible for tools, equipment, labor, and manpower to achieve this.

The Service Provider needs to make sure that the container is free from any leakage. Tools and vehicles should be operated by qualified and licensed operators. The repair, maintenance, and upgrades of the tools and equipments shall be covered by the Service Provider.

VALID AND ACCEPTABLE WASTE

The Service Provider agrees to dispose of Waste products in a valid and assigned disposal area. The Service Provider confirms that they will not dispose of the Waste products in sewers, rivers, swamps, and locations that are not in the agreed assigned area. The Service Provider is not allowed to collect hazardous wastes.

TERM

This Waste Management Service Agreement will start on _____ until _____.

PAYMENT AND FEES

Payments should be made on a monthly basis. The payment will depend on the level and number of services provided. A document will be shown that indicates the total amount as an invoice.

The Service Provider will be responsible for any taxes, tariff fees, or any local laws and regulations.

Waste Management Service Agreement

DISPOSAL RATES

The Service Provider and the Client or Waste Generator agree to the following:

| | Description | Method | Rate | Fees Total | Transportation Type |
|---|-------------|--------|------|------------|---------------------|
| 1 | | | | | |
| 2 | | | | | |
| 3 | | | | | |
| 4 | | | | | |
| 5 | | | | | |

INSPECTION AND MONITORING

The Client or Waste Generator has the right to conduct inspection and performance status monitoring. The Service Provider should cooperate willfully with honesty and integrity.

INDEMNIFICATION

The Client or Waste Generator indemnifies, holds harmless, and defends its employees and its affiliates against all expenses, claims, injuries, or deaths. The Service Provider should comply with all safety precautions and should provide insurance to their employees.

REPRESENTATIONS AND WARRANTIES

The Service Provider is a valid and existing organization that is trusted by many clients. They have their own authority to practice corporate power, perform all legal obligations, and make logical decisions.

INSURANCE

The Service Provider should cover the insurance of their employees, vehicles, tools, and equipment.

TERMINATION

This Waste Management Service Agreement can be terminated if the parties involved violated the terms, conditions, and agreement in this document

CONFIDENTIALITY

The content of this Waste Management Service Agreement is considered strictly confidential. If a third party needs to view it, written approval or authorization should be provided by both parties.

Waste Management Service Agreement

ASSIGNMENT

The Service Provider is not allowed to assign or transfer the services to a third party unless permission is granted for sub-contracting.

HEADINGS AND TITLES

The Headings and Titles in this Waste Management Service Agreement are arranged and positioned as a reference only, it cannot be used to translate word for word or to interpret this Agreement.

AMENDMENT

No modification or change of this Waste Management Service Agreement shall be considered valid unless made in writing and agreed upon by the involved parties.

SEVERABILITY

Any provision found in this Waste Management Service Agreement shall be held illegal, invalid, or unenforceable by any competent court, the same shall apply only to the provision and the rest of the remaining provisions hereto shall remain valid.

ENTIRE AGREEMENT

This Waste Management Service Agreement represents the agreement between the parties involved. Any agreements made such as prior understandings, either oral or written, which are not incorporated into the conditions herein will be invalid.

GOVERNING LAW

This Waste Management Service Agreement shall be governed under the law of _____.

SIGNATURE

By signing below, you agreed to the terms and conditions, payments, and all the content of this Waste Management Service Agreement.

Service Provider Rep

Client Representative



Thanks for using **Waste Management Service Agreement!** To edit this PDF with **Jotform Sign**, sign up for a free Jotform account today.

[EDIT PDF](#)

Learn More About Jotform PDF Products

Jotform offers powerful PDF solutions. Check them out below.

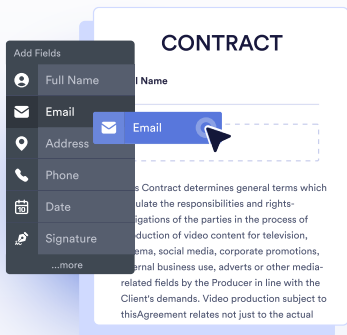

JOTFORM PDF EDITOR

Turn form submissions into PDFs automatically — ready to download or save for your records.

[Go to PDF Editor >](#)

SMART PDF FORMS

Convert your PDF files into online forms that are easy to fill out on any device.

[Go to Smart PDF Forms >](#)

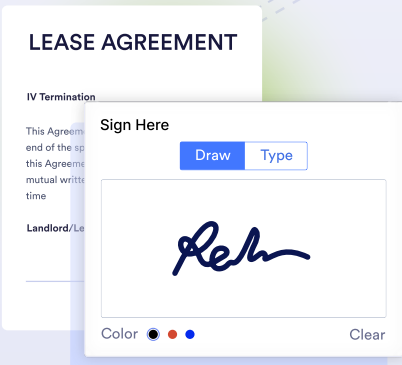
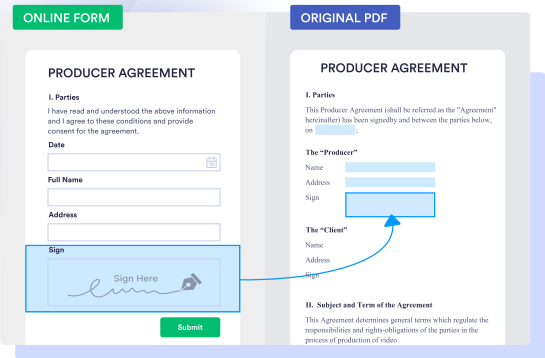

JOTFORM SIGN

Collect e-signatures with Jotform Sign to automate your signing process.

[Go to Jotform Sign >](#)

These templates are suggested forms only. If you're using a form as a contract, or to gather personal (or personal health) info, or for some other purpose with legal implications, we recommend that you do your homework to ensure you are complying with applicable laws and that you consult an attorney before relying on any particular form.